

## The AutoMARK Voter Assistance Terminal Operating Instructions

Insert your paper ballot into the machine and it will be displayed on the screen. You can touch the screen to vote or use a Braille keypad or your own sip-and-puff device. You can zoom in to make the text larger or change the contrast to make the ballot easier to read. You can also listen to the audio ballot and instructions with headphones and vote.

Here is a link to a recording of the [Operating Instructions - "How to vote on the AutoMARK"](#). MP3-Audio

Here is a link to a Captioned Video. ["Voting on the AutoMARK"](#). MP4 -Video.

Below is a picture of the AutoMARK Voter Assistance Terminal.

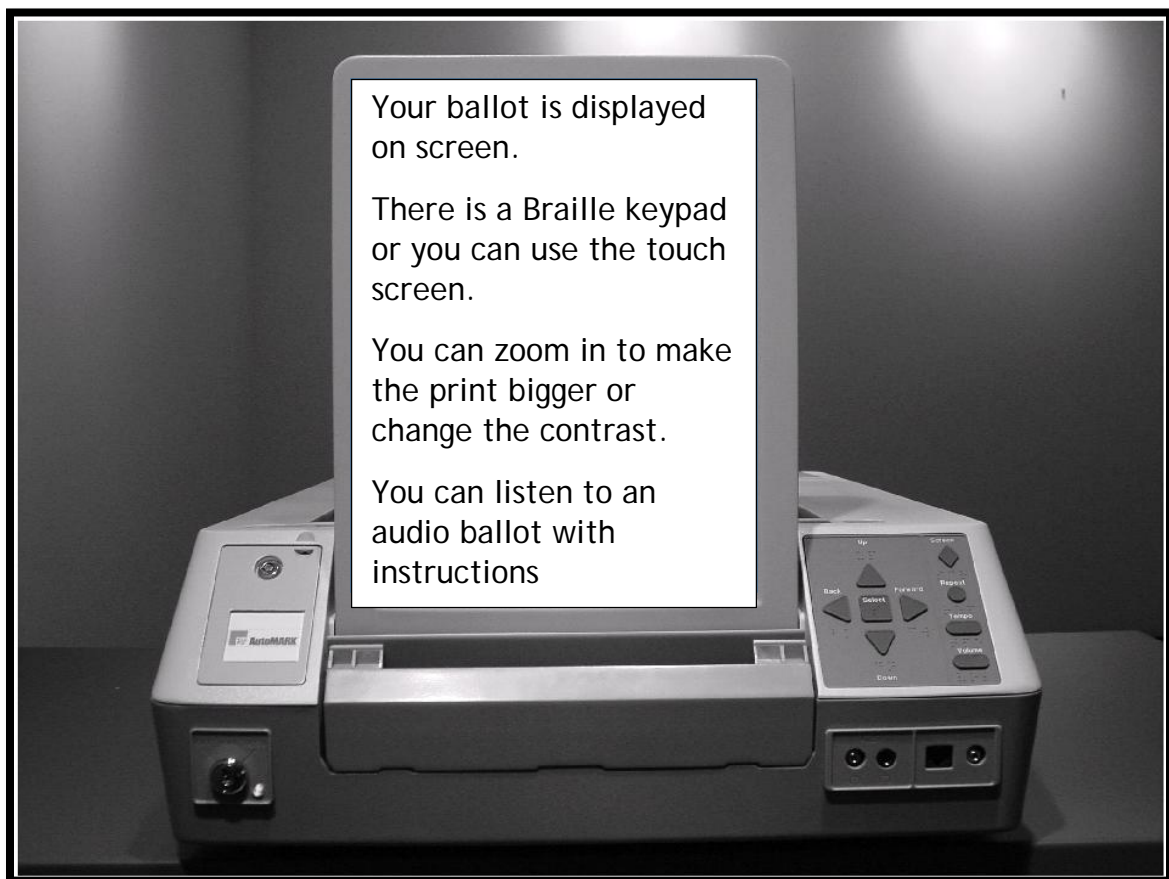

### Operating Instructions - How to vote on the AutoMARK.

Below is a picture from the manufacturer of the AutoMARK. It shows where to insert your paper ballot. If you ask, a poll worker can assist you. The picture also shows the touch screen, the Braille keypad, and how to use the headphones to hear the audio ballot. The picture is captioned as follows:

**Inserting your ballot.** Insert your ballot into the ballot slot on the front of the machine. The machine will pull it forward once it is inserted far enough. This is also where your ballot will be returned.

**Audio - Ballot Read Aloud.** Headphones can be plugged into the front of the device to hear the ballot. Accessible devices such as two-switch paddles and sip and puff tubes can also be plugged in to the front of the device.

**Marking your vote.** Once the ballot has been inserted, the machine will allow you to mark your ballot using the touch screen. If you are using headphones, the ballot will be read to you along with instructions on how to select your vote choice.

**Using the Keypad.** The keypad has different shaped buttons. There is a detailed picture below. It can be also be used to adjust volume, tempo of the spoken word, to repeat questions and to mark your vote choices.



### Detailed picture of the Braille Keypad.

Below is a detailed picture of the keypad and the selection buttons. The buttons are different shapes and labeled with Braille. The picture is captioned as follows:

The square button in the center of the keypad selects choices. The triangle up button is above the select button, the triangle down button is below the select button. The triangle forward button is to the right of the select button and the triangle back button is to the left of the select button.

There are four buttons running down the right side of the keypad. The top diamond button turns the screen off for privacy. The second round button repeats spoken words on the audio ballot. The third button is an oval and adjust the tempo of the spoken words. And the bottom oval button adjusts the volume.

